

FERRARI

72 S

COFANO MOTORE  
CAPE MOTOR  
ENGINE COVER

CAPO MOTOR  
COFFRE MOTEUR  
MOTORHAUBE

PAGINA  
01.00  
DATA  
01 SET. 1991

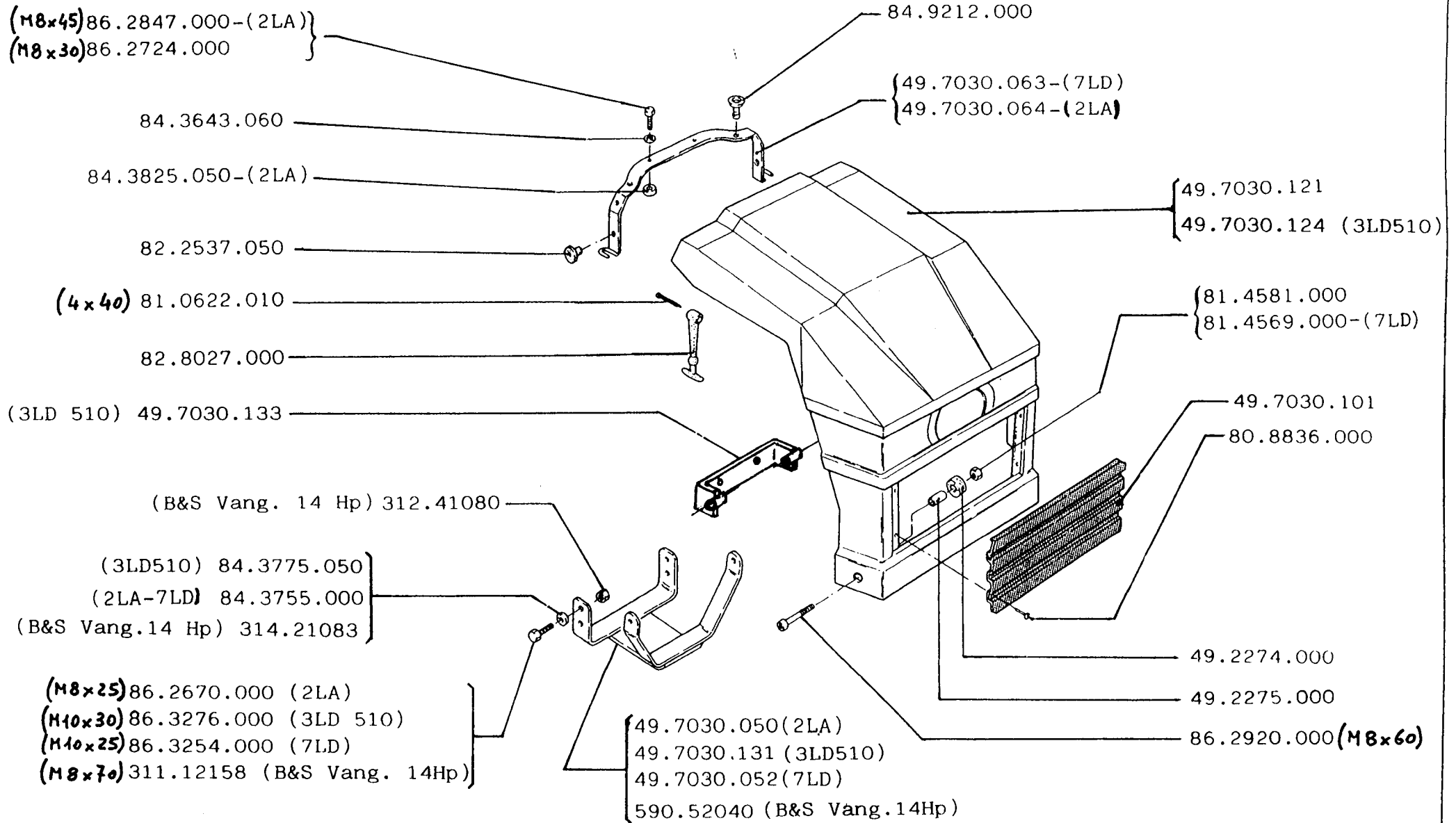

FERRARI

**72 S**

COFANO MOTORE  
 CAPE MOTOR  
 ENGINE COVER

CAPO MOTOR  
 COFFRE MOTEUR  
 MOTORHAUBE

PAGINA  
**01.01**  
 DATA  
 - 1 AGO. 1996

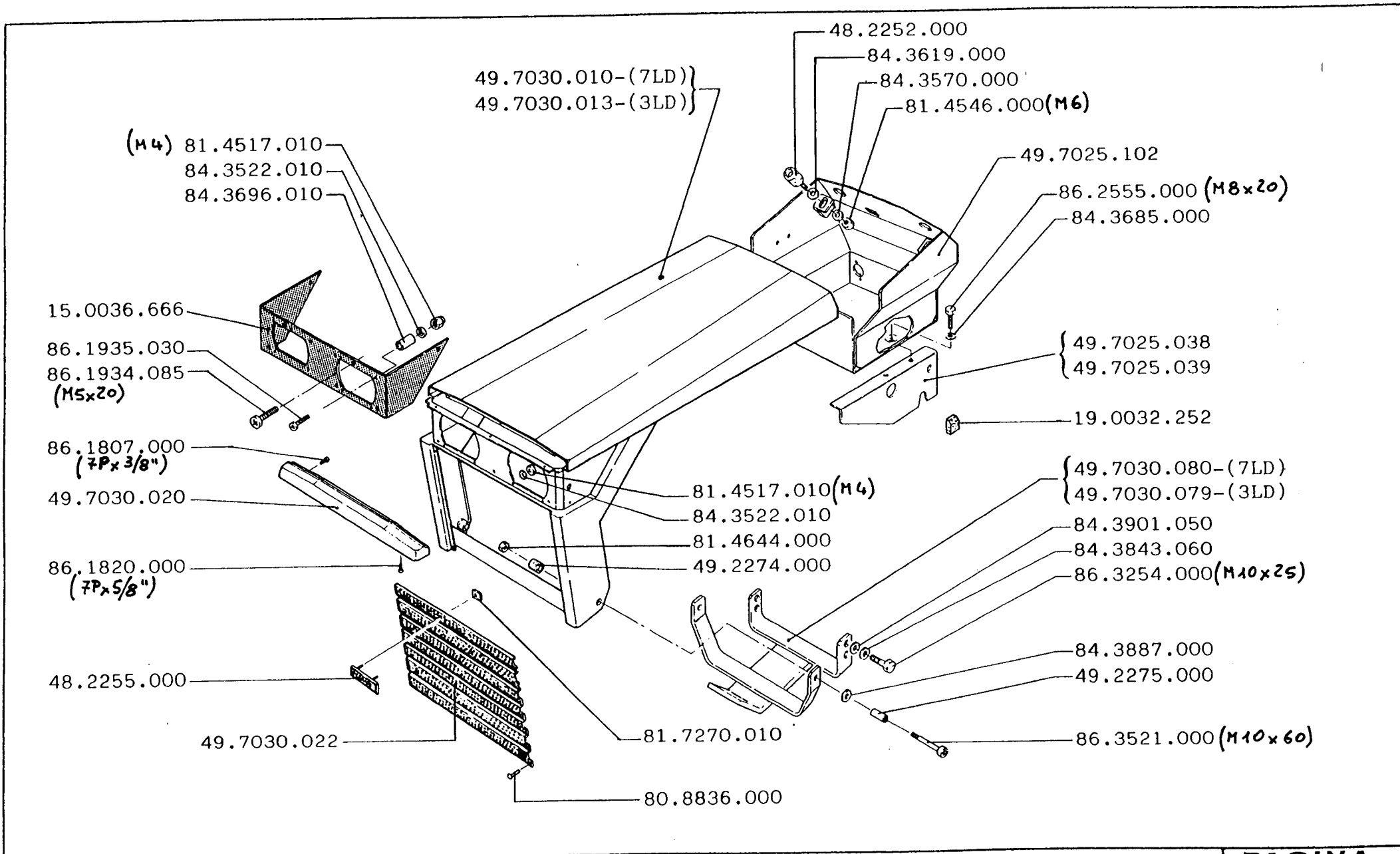

FERRARI

72 S

COFANO MOTORE CON AVV. EL.  
 CAPE MOTOR SIST. ELECTRICO  
 ENGINE COVER WITH EL.STARTER

CAPO MOTOR ARR. ELECTRICO  
 COFFRE MOTEUR AVEC DEM. ELEC.  
 MOTORHAUBE MIT ELEKTROSTART

PAGINA  
 02.00  
 DATA  
 C 1 SET. 1991

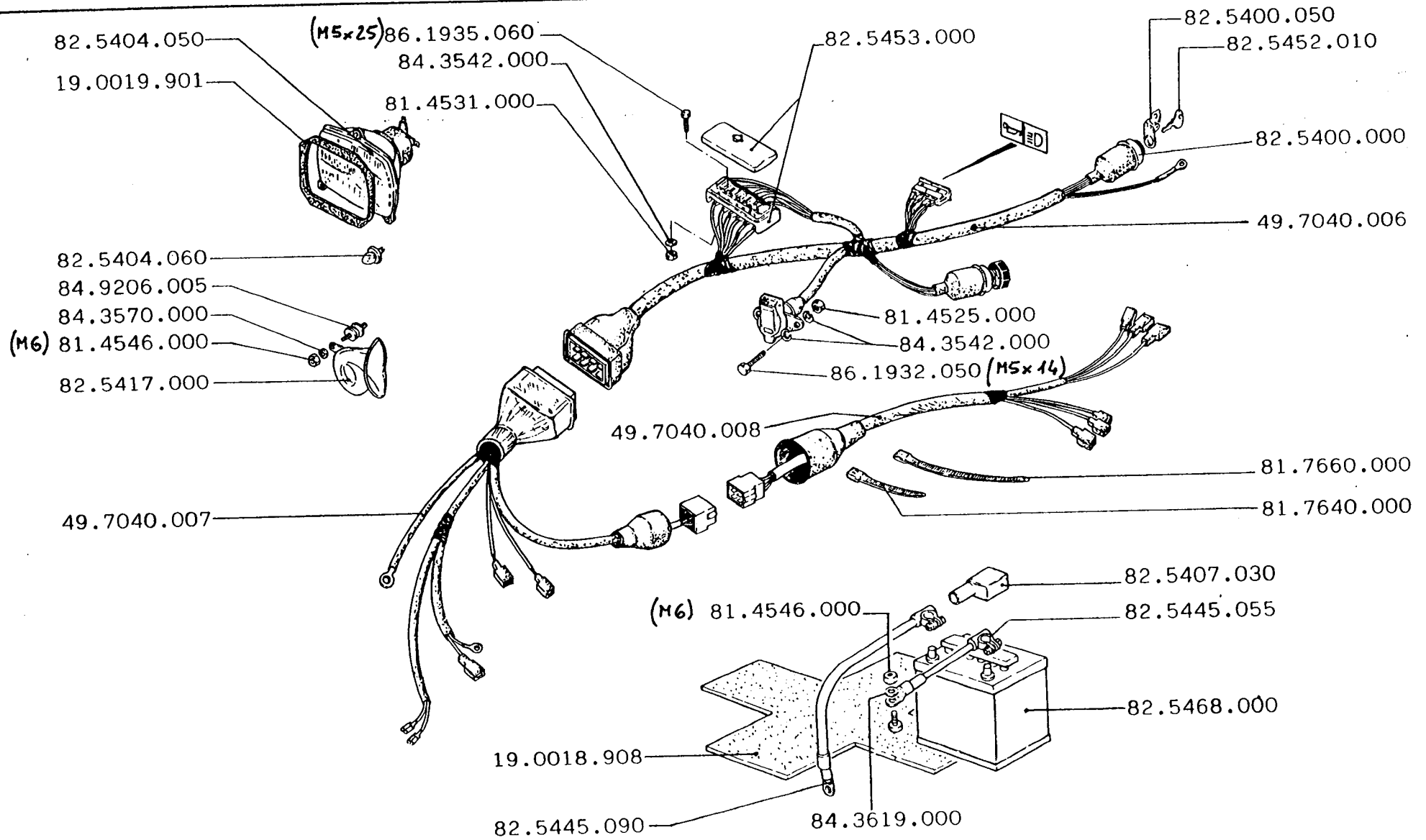

FERRARI

72 S

AVVIAMENTO ELETTRICO  
 SISTEMA ELECTRICO  
 ELECTRIC STARTER

ARRANQUE ELECTRICO  
 DEMARRAGE ELECTRIQUE  
 ELEKTROSTART

PAGINA  
 03.00  
 DATA  
 01 SET. 1991

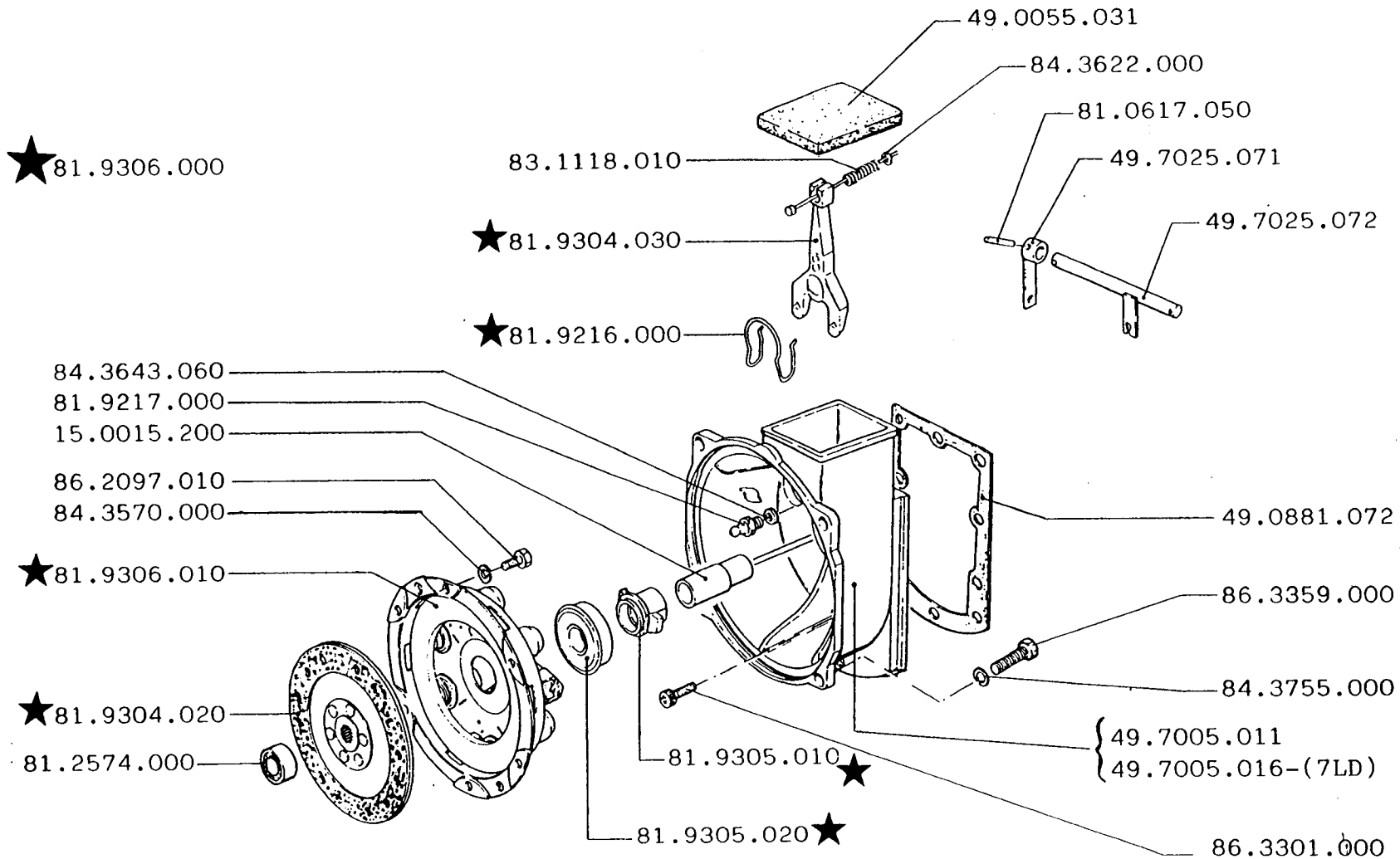

FERRARI

**72 S**

FRIZIONE  
 EMBRAIAGEM  
 CLUTCH

EMBRAGUE  
 EMBRAYAGE  
 KUPPLUNG

PAGINA  
**04.00**  
 DATA  
 © 1 SET. 1991

**Briggs & Stratton Vanguard**

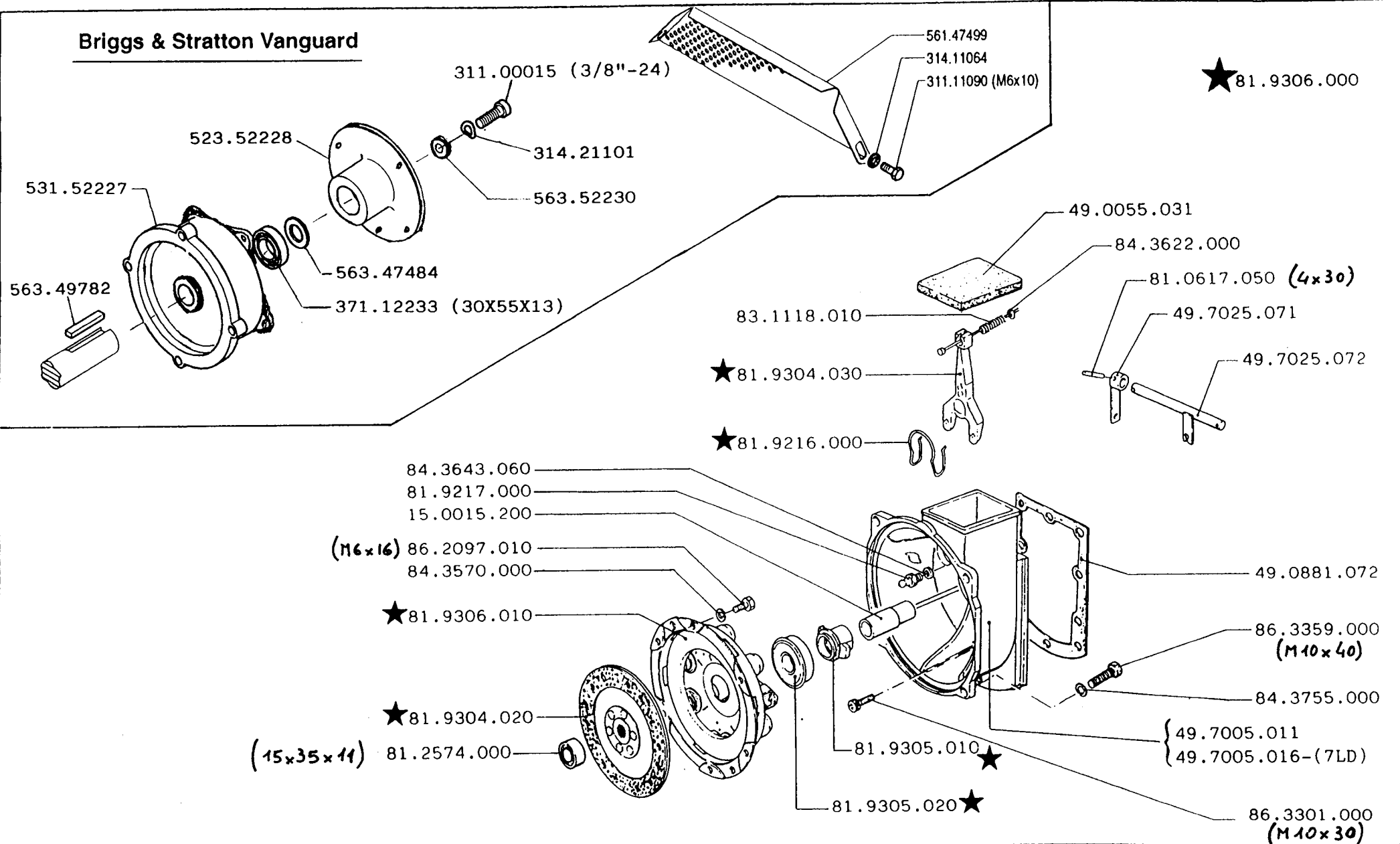

**FERRARI**

**72 S**

FRIZIONE  
EMBRAIAGEM  
CLUTCH

EMBRAGUE  
EMBAYAGE  
KUPPLUNG

PAGINA  
**04.01**  
DATA  
= 1 AGO. 1996

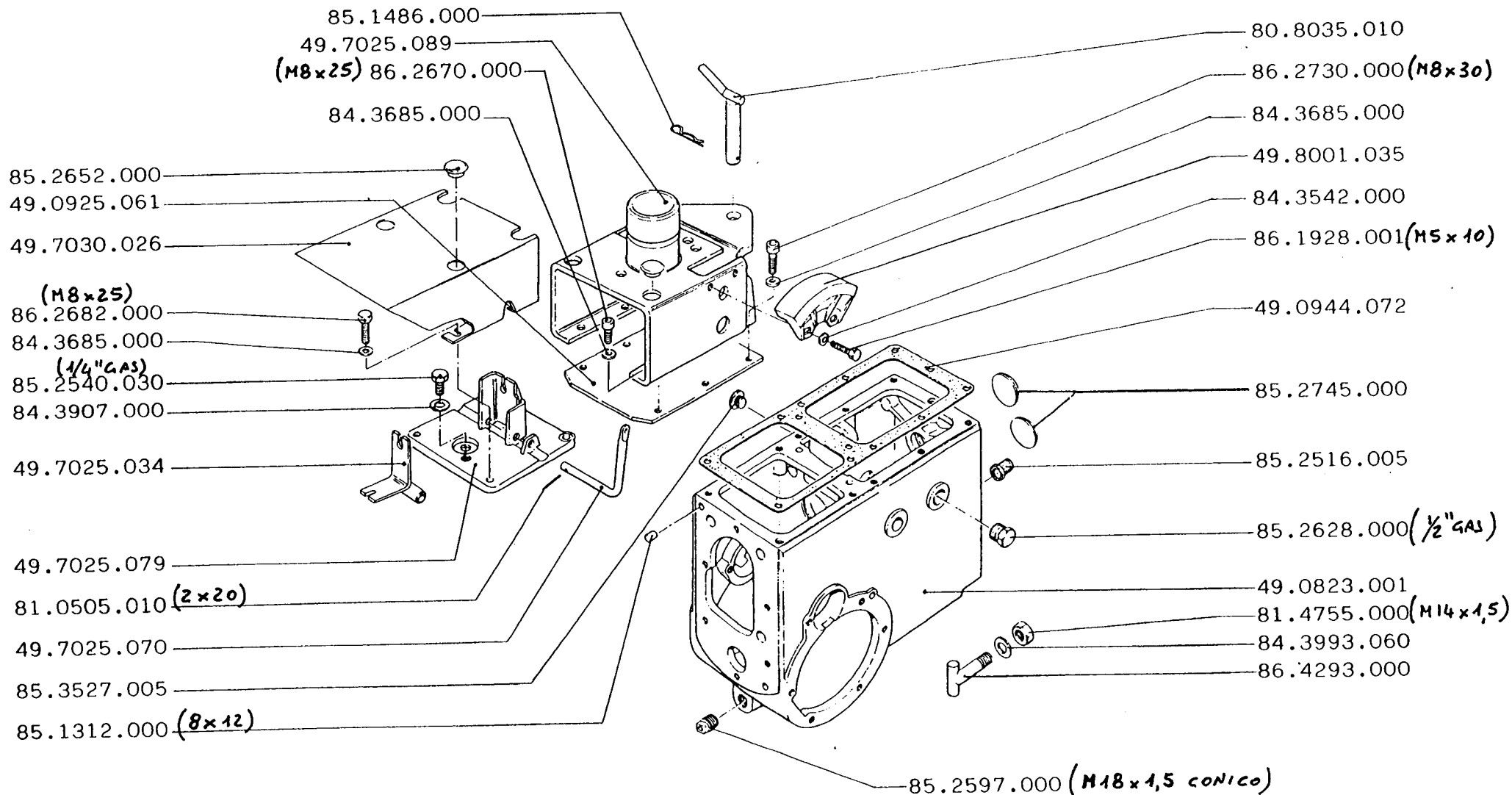

FERRARI

**72 S**

SCATOLA CAMBIO  
 CAIXA DE VELOCIDADES  
 GEARBOX

CAJA DE CAMBIO  
 BOITE DE VITESSES  
 WECHSELGETRIEBE

PAGINA  
**05.00**  
 DATA  
 C 1 SET. 1991

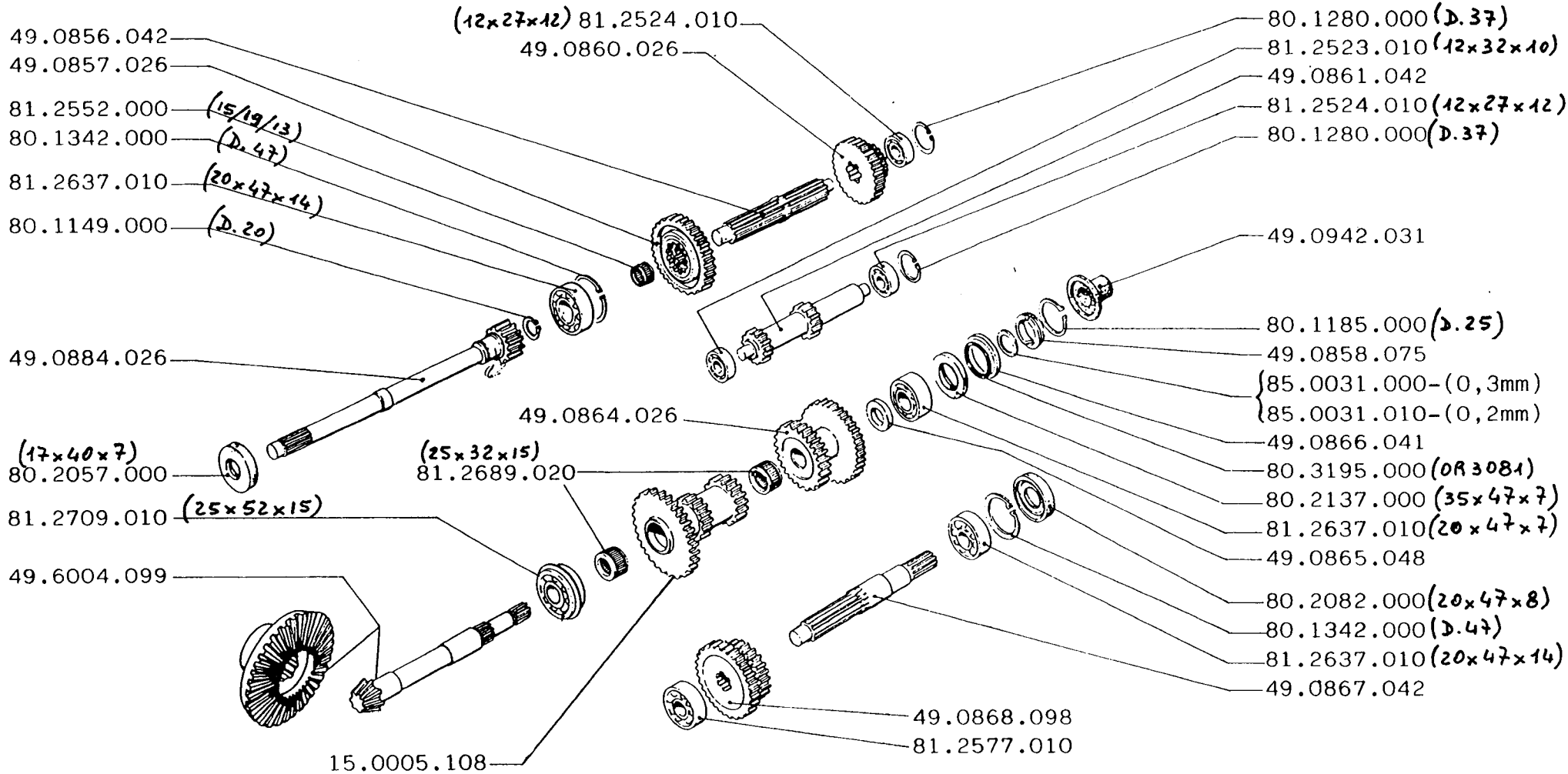

FERRARI

72 S

INGRANAGGI  
 ENGRENAGEM  
 GEARS

ENGRANAJES  
 ENGRANAGES  
 ZAHNRAEDER

PAGINA  
 06.00  
 DATA  
 01 SET. 1991



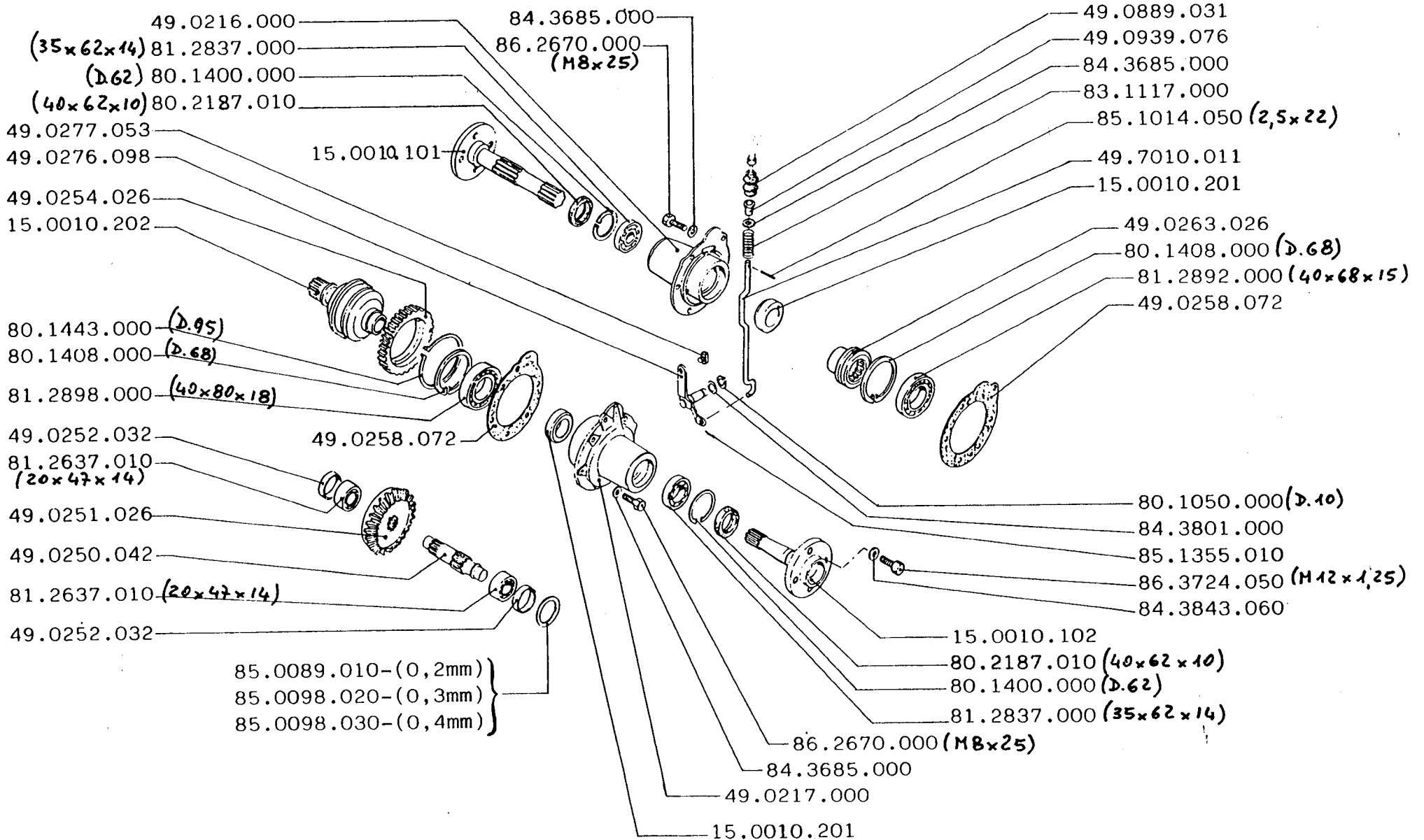

FERRARI

72 S

DIFFERENZIALE(FRENI A TAMB.)  
 DIFERENCIAL (FREIO A TAMBOR)  
 DIFFERENTIEL (BRAKES DRUM)

DIFERENCIAL(FRENOS A TAMBOR)  
 DIFFERENTIAL (FREINS TAMBOUR)  
 DIFFERENTIAL (BREMSENTROMMEL)

PAGINA  
 07.00  
 DATA  
 C 1 SET. 1991

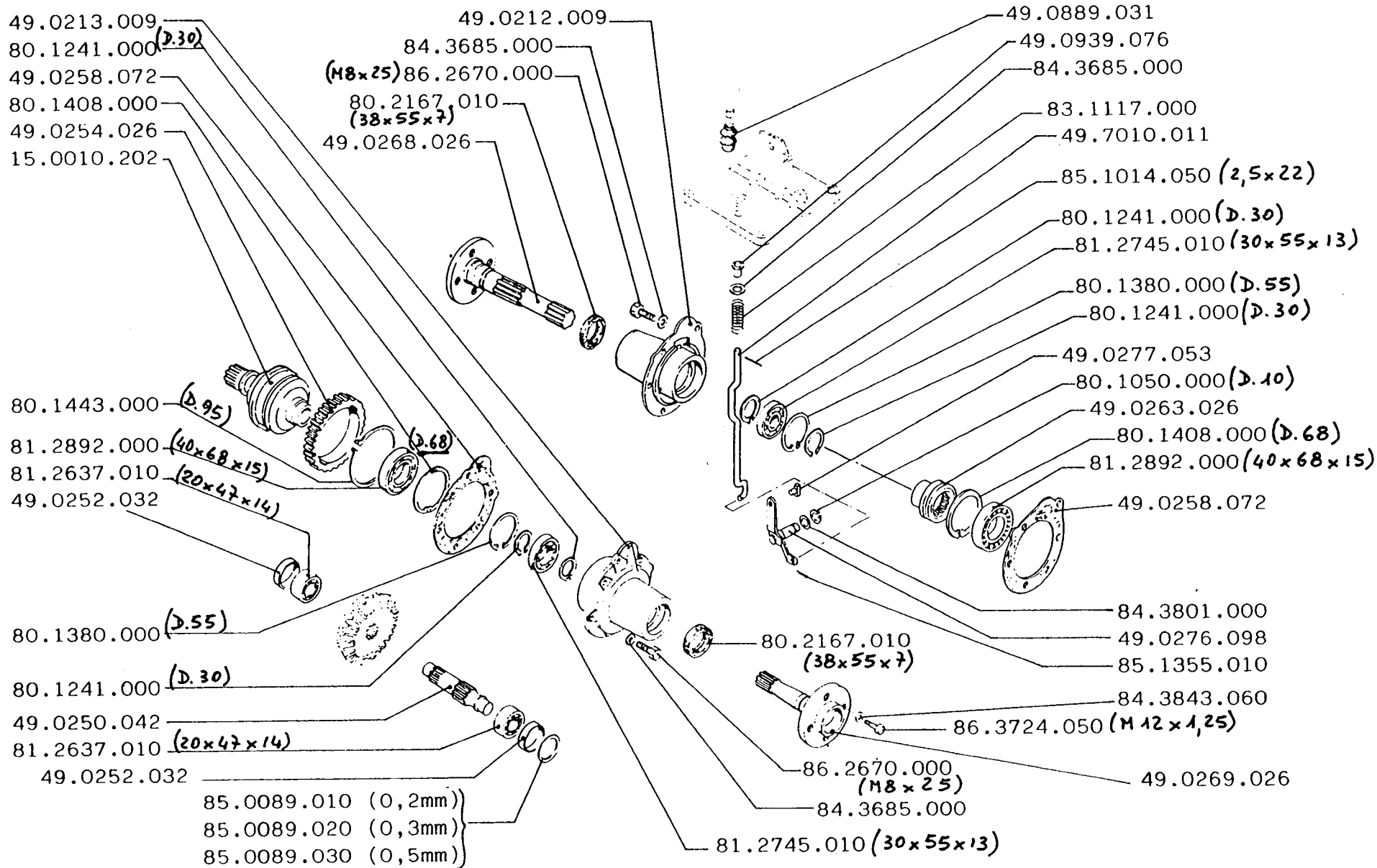

FERRARI

72 S

DIFFERENZIALE (FRENI A NASTRO)

DIFERENCIAL (FREIO A NASTRO)

DIFFERENTIEL (TWO LEADING SHOE BRAKE)

DIFERENCIAL (FRENOS DE CINTA)

DIFFERENTIAL (FREINS RUBAN)

DIFFERENTIAL (BANDBREMSEN)

PAGINA

08.00

DATA

1 SET. 1991

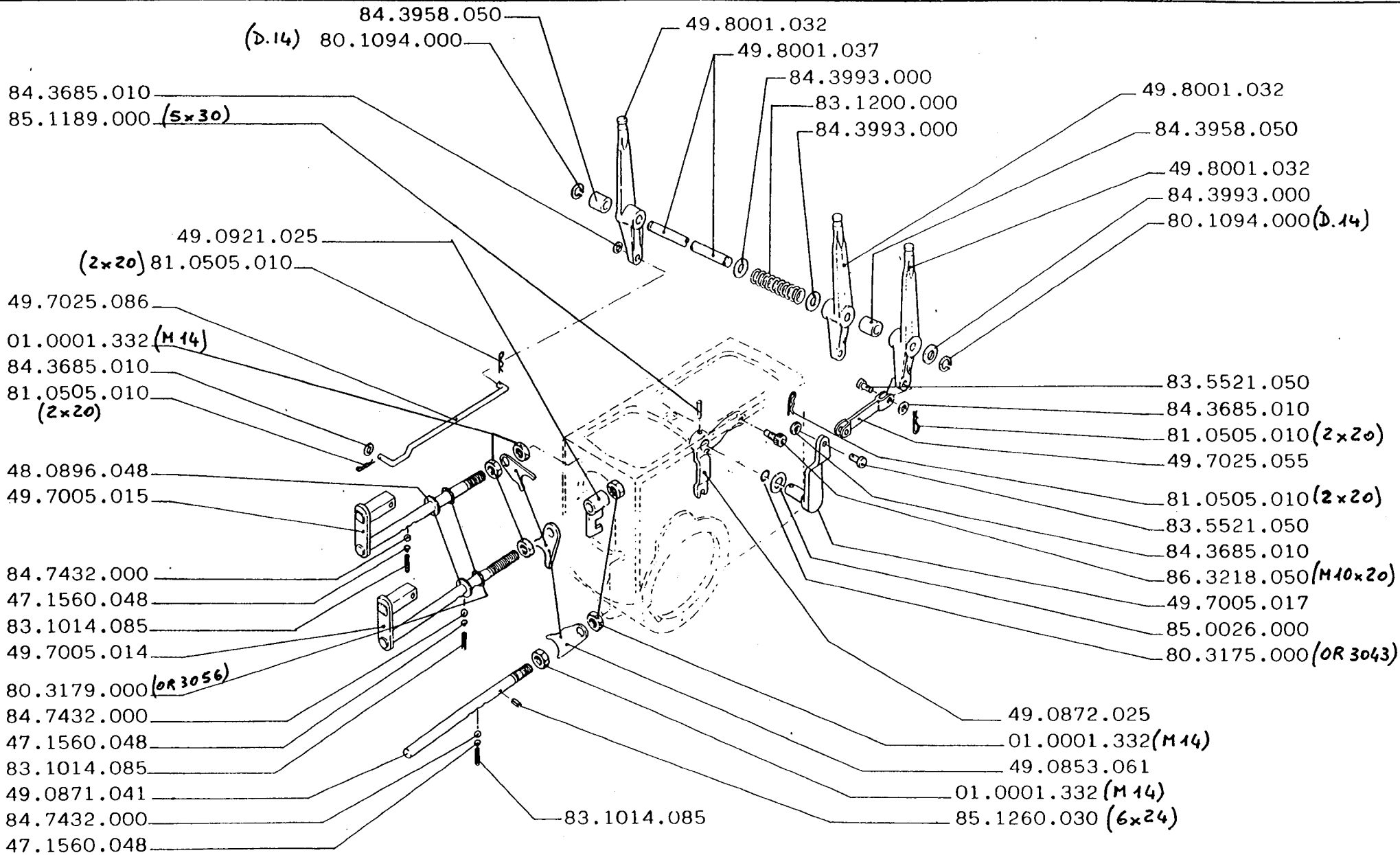

FERRARI

72 S

COMANDI  
COMANDOS  
CONTROLS

MANDOS  
COMMANDES  
ANTRIEBE

PAGINA  
09.00  
DATA  
01 SET. 1991

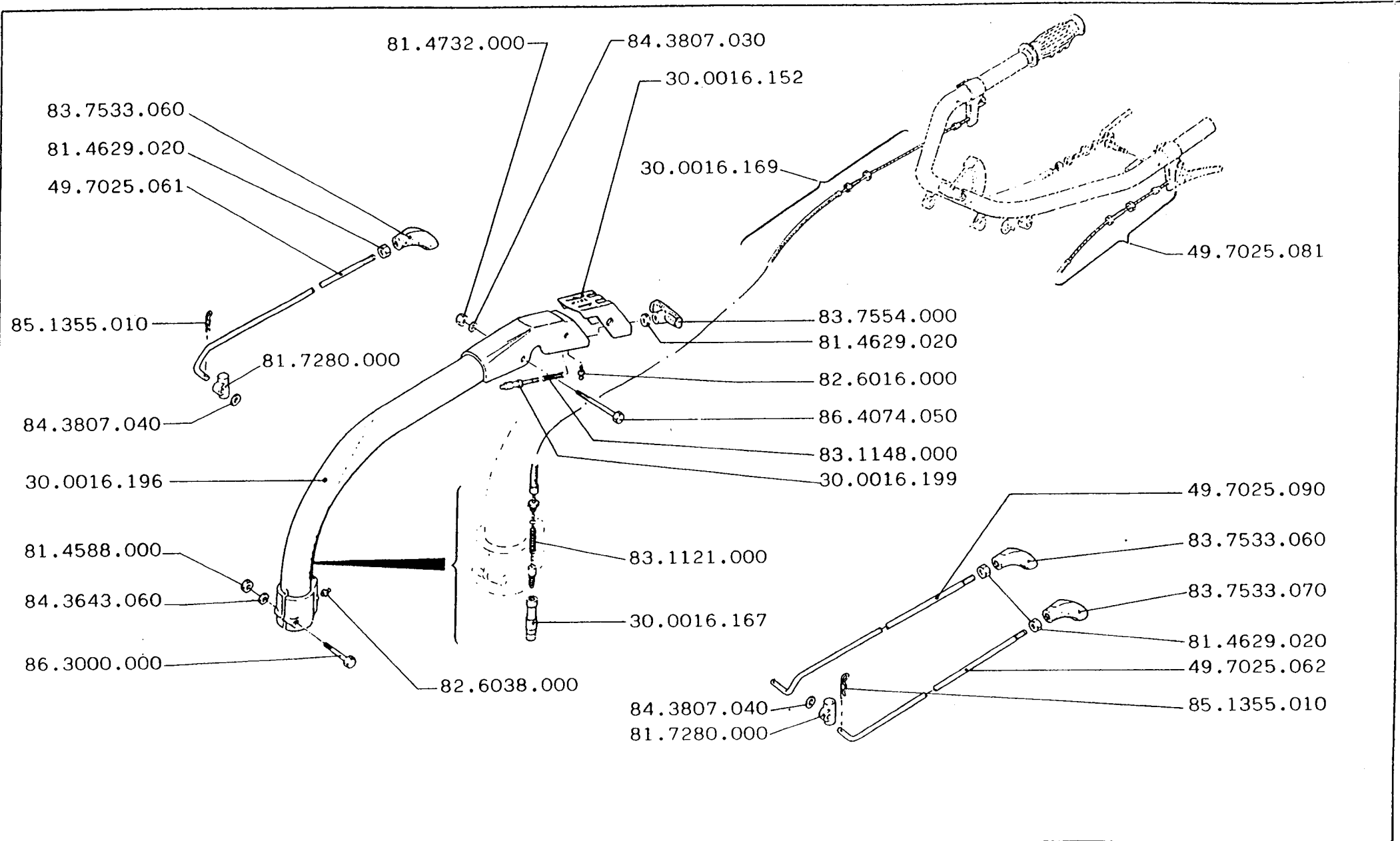

FERRARI

**72 S**

STEGOLA  
COLUNA  
STEERING COLUMN

COLUMNA  
PLANTON  
LENKSAEULE

PAGINA  
**10.00**  
DATA  
01 SET. 1991

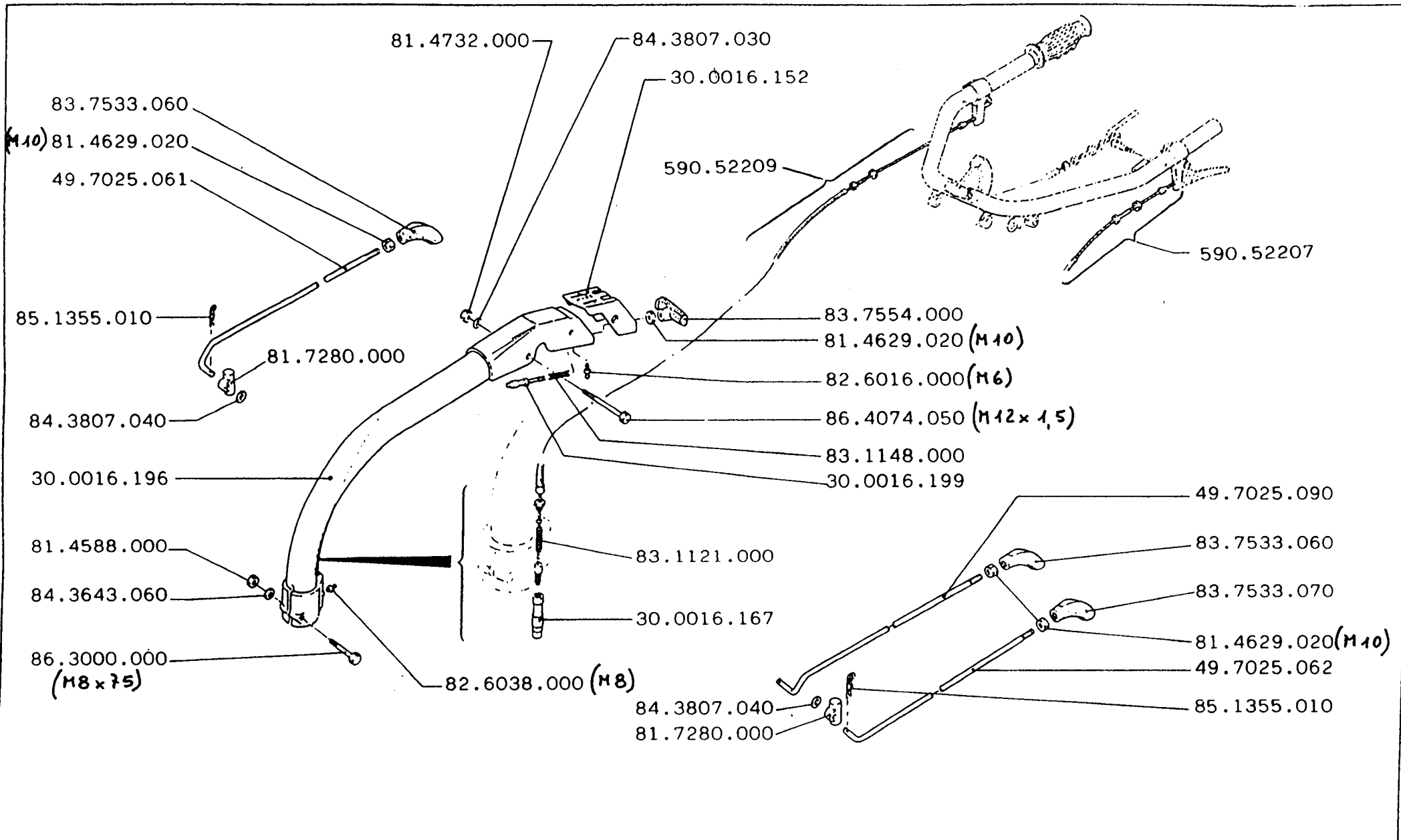

FERRARI

**72 S**

STEGOLA  
COLUNA  
STEERING COLUMN

COLUMNA  
PLANTON  
LENKSAEULE

PAGINA  
**10.01**  
DATA  
- 1 AGO. 1996

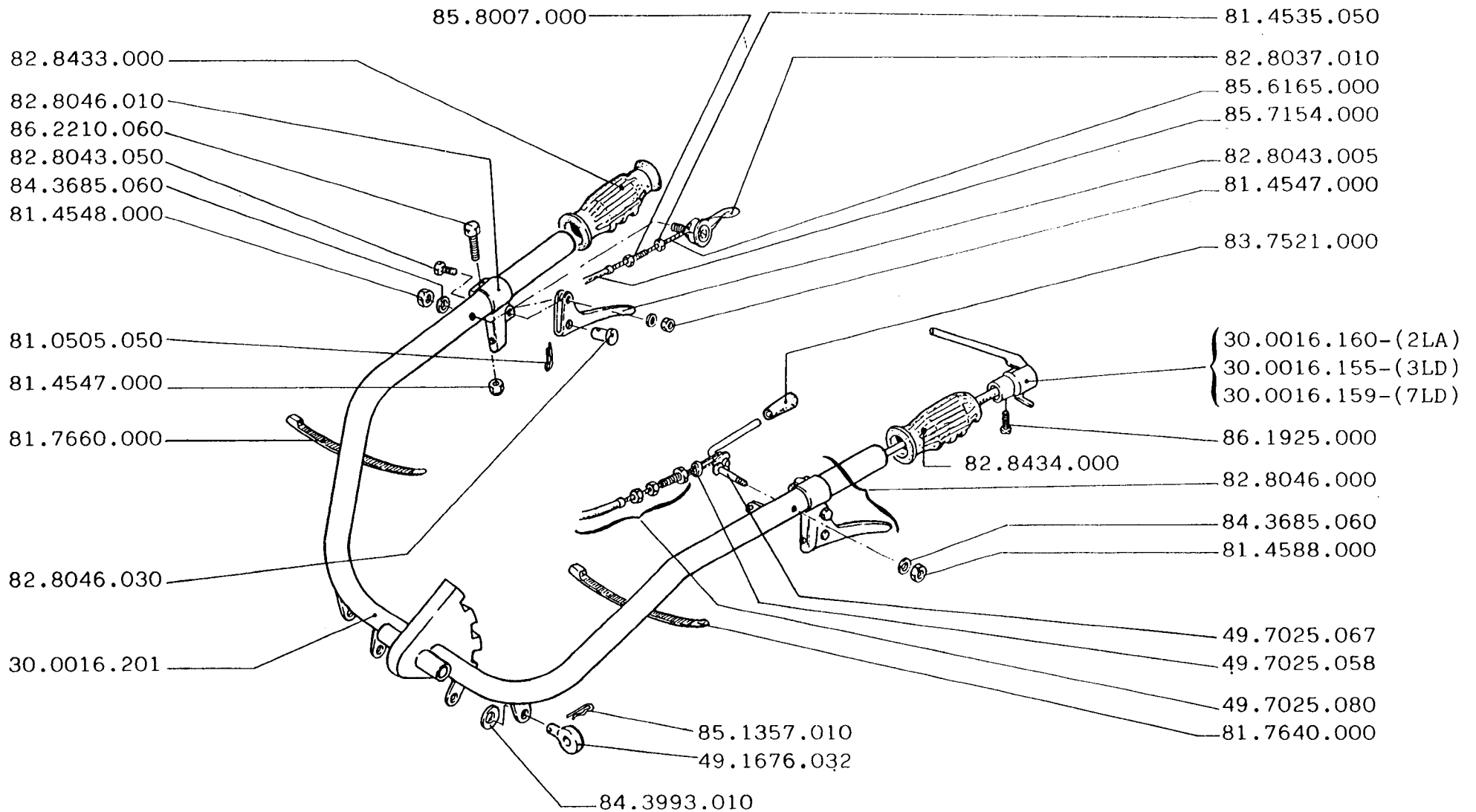

**FERRARI**

**72 S**

MANUBRIO  
MANUBRIO  
HANDLEBAR

MANILLAR  
MANCHERON  
LENKER

PAGINA  
**11.00**  
DATA  
01 SET. 1991

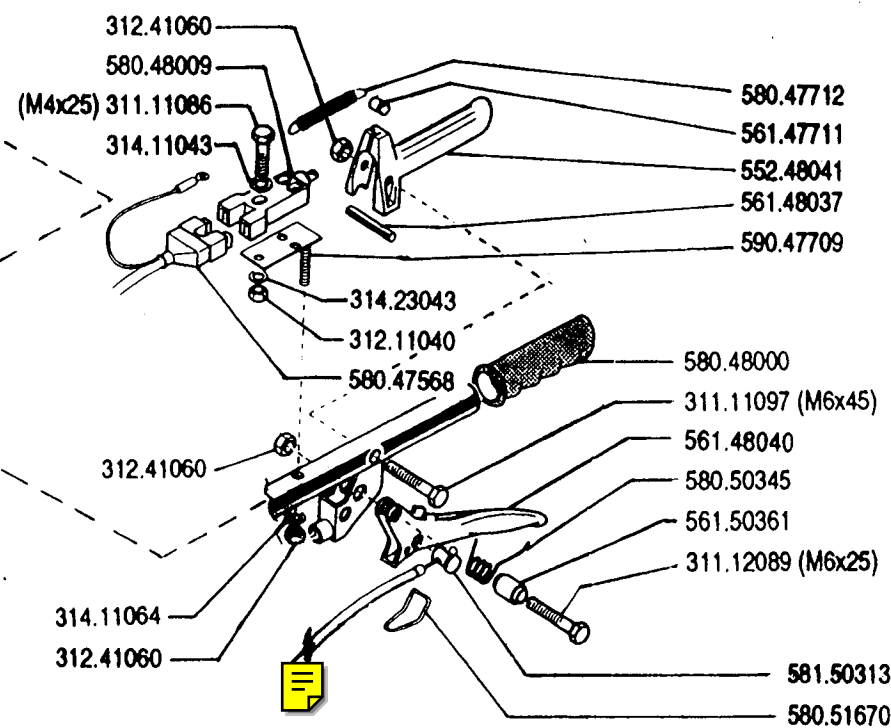
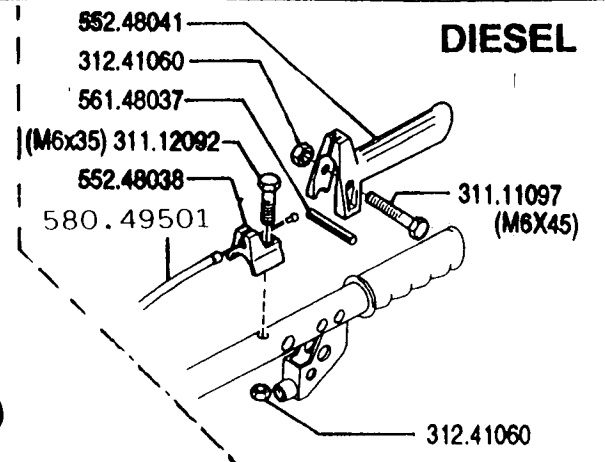
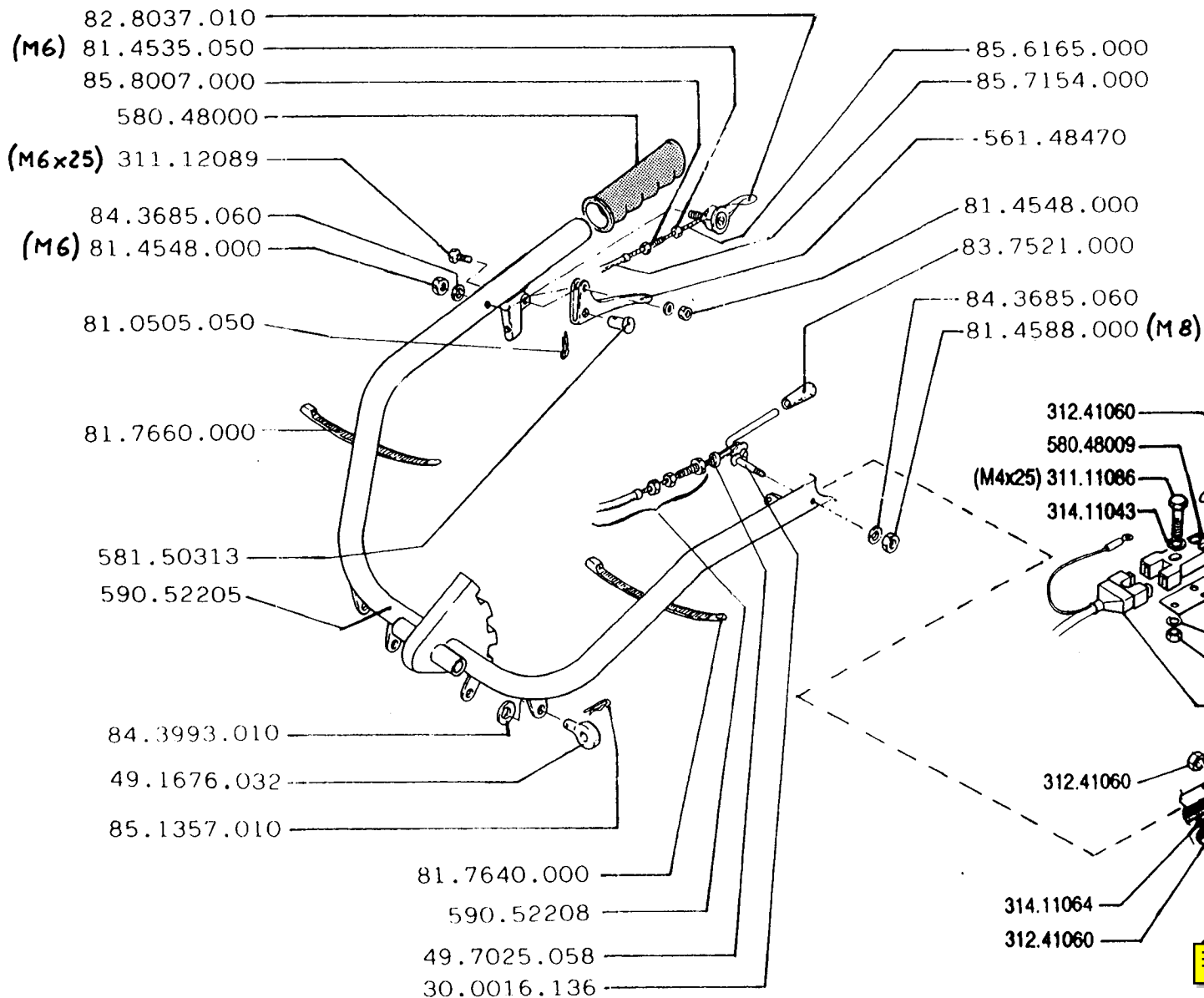

FERRARI

**72 S**

MANUBRIO  
 MANUBRIO  
 HANDLEBAR

MANILLAR  
 MANCHERON  
 LENKER

PAGINA  
**11.01**  
 DATA  
 - 1 AGO. 1996

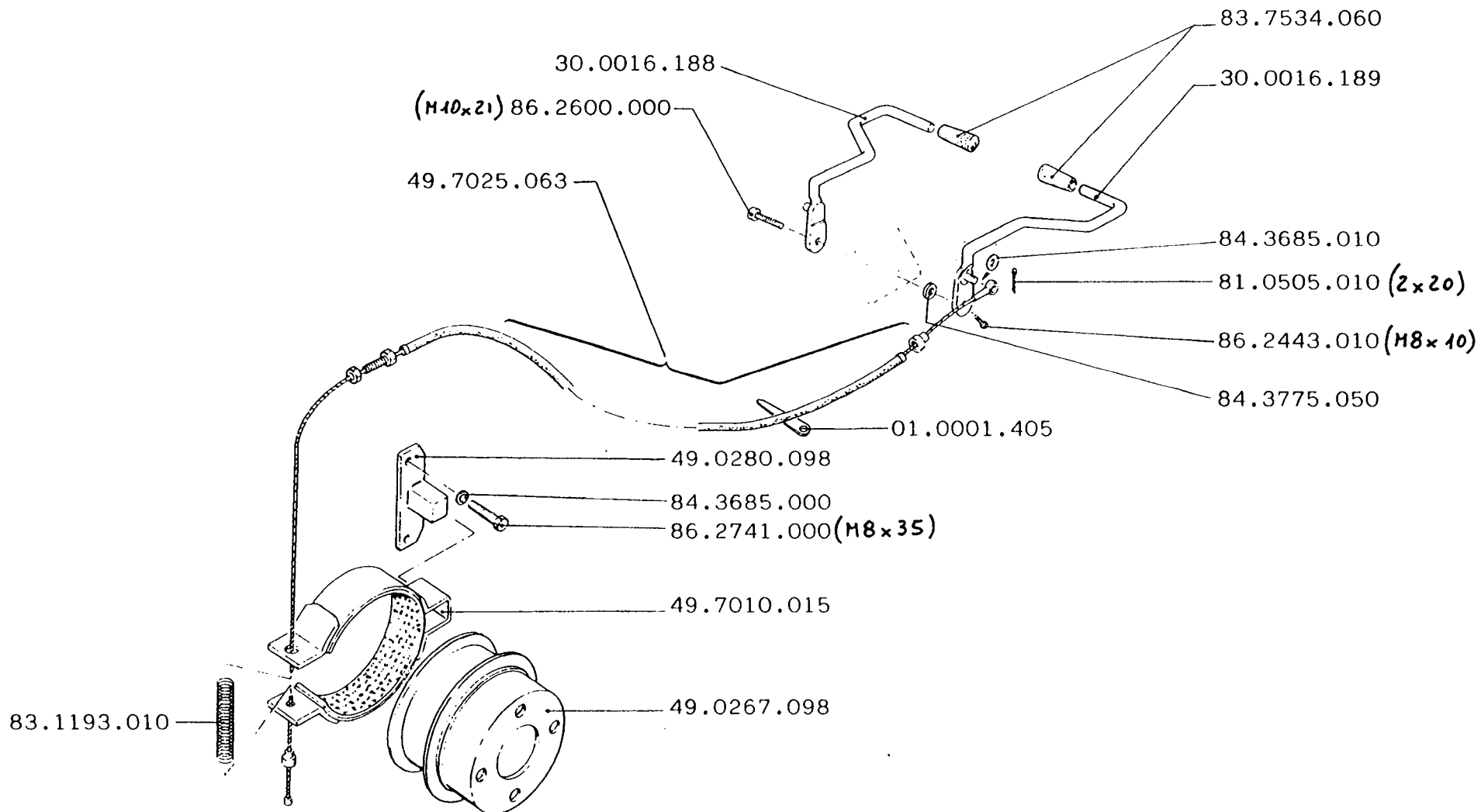

FERRARI

725

FRENI A NASTRO  
 FREIO A NASTRO  
 TWO LEADING SHOE BRAKE

FRENOS DE CINTA  
 FREIN A RUBAN  
 BANDBREMSE

PAGINA  
 12.00  
 DATA  
 01 SET. 1991



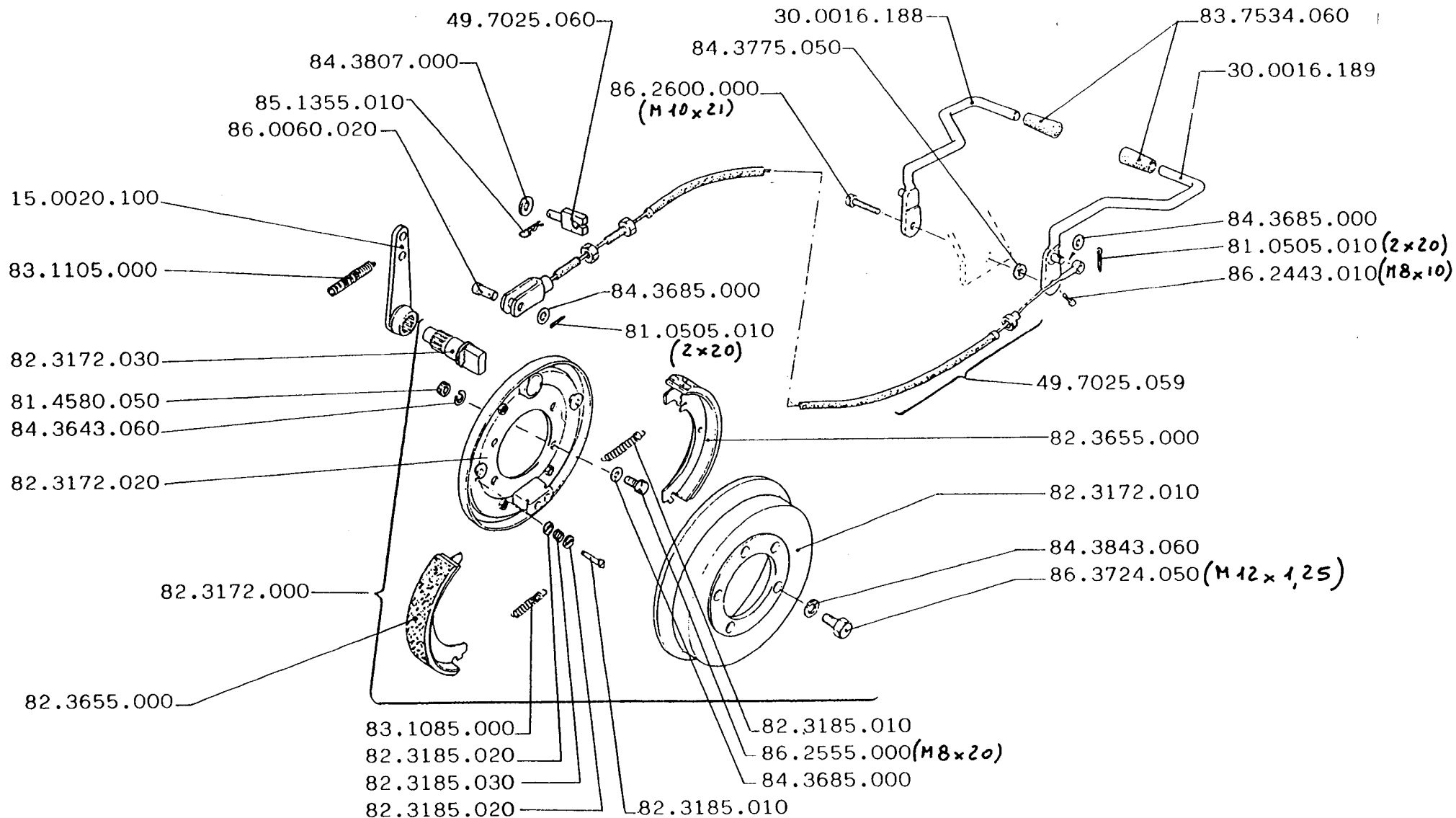

FERRARI

**72 S**

FRENI A TAMBURO  
FREIO A TAMBOR  
DRUM BRAKE

FRENOS DE EXPANSION  
FREIN A TAMBOR  
BRACKENBREMSE

PAGINA  
**13.00**  
DATA  
01 SET. 1991

5.00-12	84.8538.000	84.8832.000	84.9030.000	90.6016.000
6.5-80/12	84.8530.000	84.8835.000	84.9043.000	90.6016.000
6.5-80/15	84.8564.000	84.8847.000	84.9099.040	90.6016.000

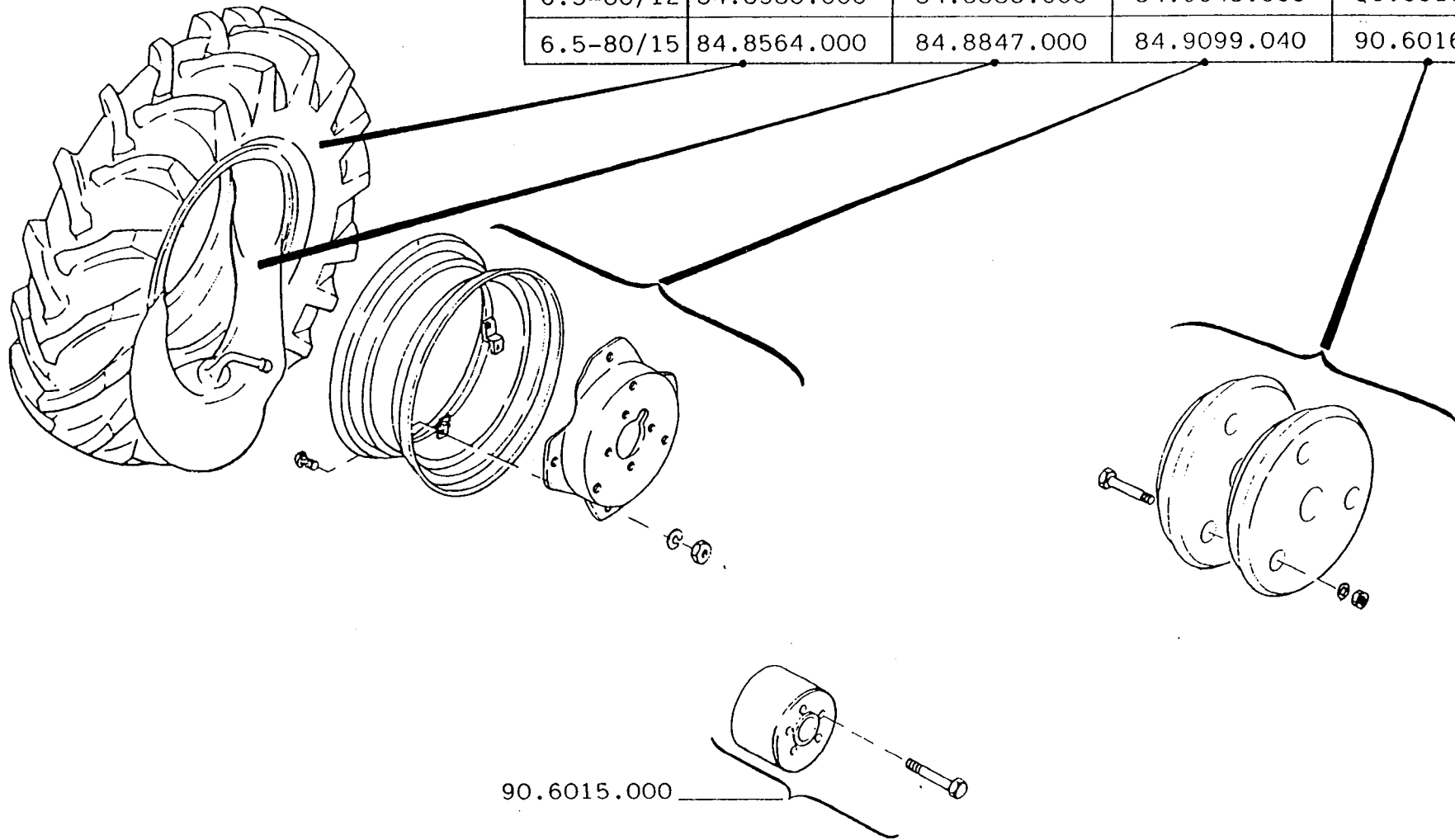

FERRARI

**725**

RUOTE E ACCESSORI  
 RODAS/ACESSORI  
 WHEELS AND TOOL KIT

RUEDAS/ACCESORIOS  
 ROUES/ACCESSOIRES  
 RADER UND WERKZEUGSATZ

PAGINA  
**14.00**  
 DATA  
 01 SET. 1991



85.4210.063  
85.4210.064

ATTENZIONE! PRIMA DI INVERTIRE LA STEGOLA, PORTARE LE LEVE NELLA POSIZIONE INDICATA DALLO SCHEMA.

ATTENTION! BEFORE TURNING THE HANDLEBAR, SET ALL LEVERS AS SHOWN IN THE DIAGRAM.

ATTENTION! AVANT DE INVERSER LE MANCHERON, METTRE LES LEVIERS DANS LA POSITION INDIQUEE PAR LE SCHEMA.

ACHTUNG! BEVOR DEN HOLMEN UMSCHALTEN, STELLEN DIE HEBEL IN DER STELLUNG AUF DEM PLAN BEZEICHNET.

49.7030.109



85.4210.065  
85.4210.066

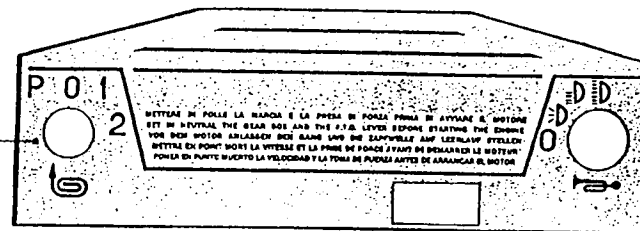

49.7030.125

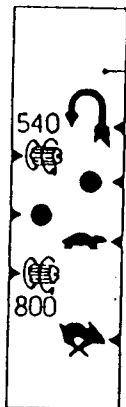

49.7030.107

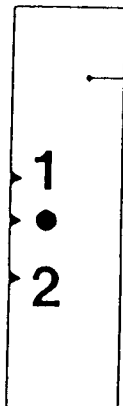

49.7030.106

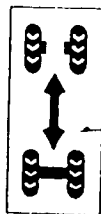

85.3811.000



85.4075.012

FERRARI

72 5

TARGHETTE ADESIVE  
ADESIVO  
ADHESIVE

AUTOADHESIVO  
AUTOADHESIF  
AUFKLEBER

PAGINA  
15.00  
DATA  
01 SET. 1991

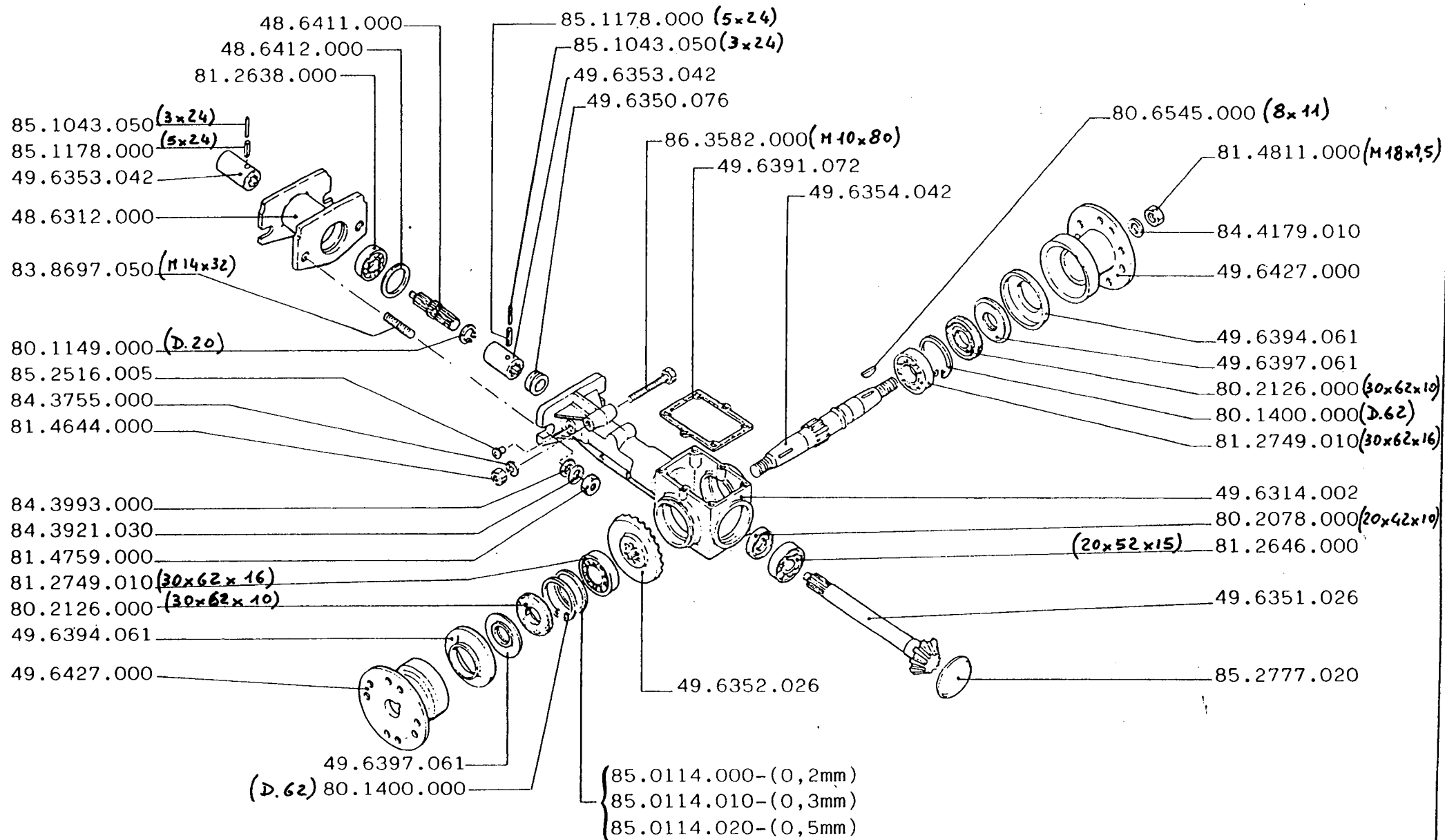

FERRARI

72 S

COMANDO FRESA  
 COMANDO FREZA  
 ROTARY HOE CONTROL

MANDO FRESADORA  
 COMMANDE FRAISE  
 FRASERANTRIEB

PAGINA  
 16.00  
 DATA  
 01 SET. 1991

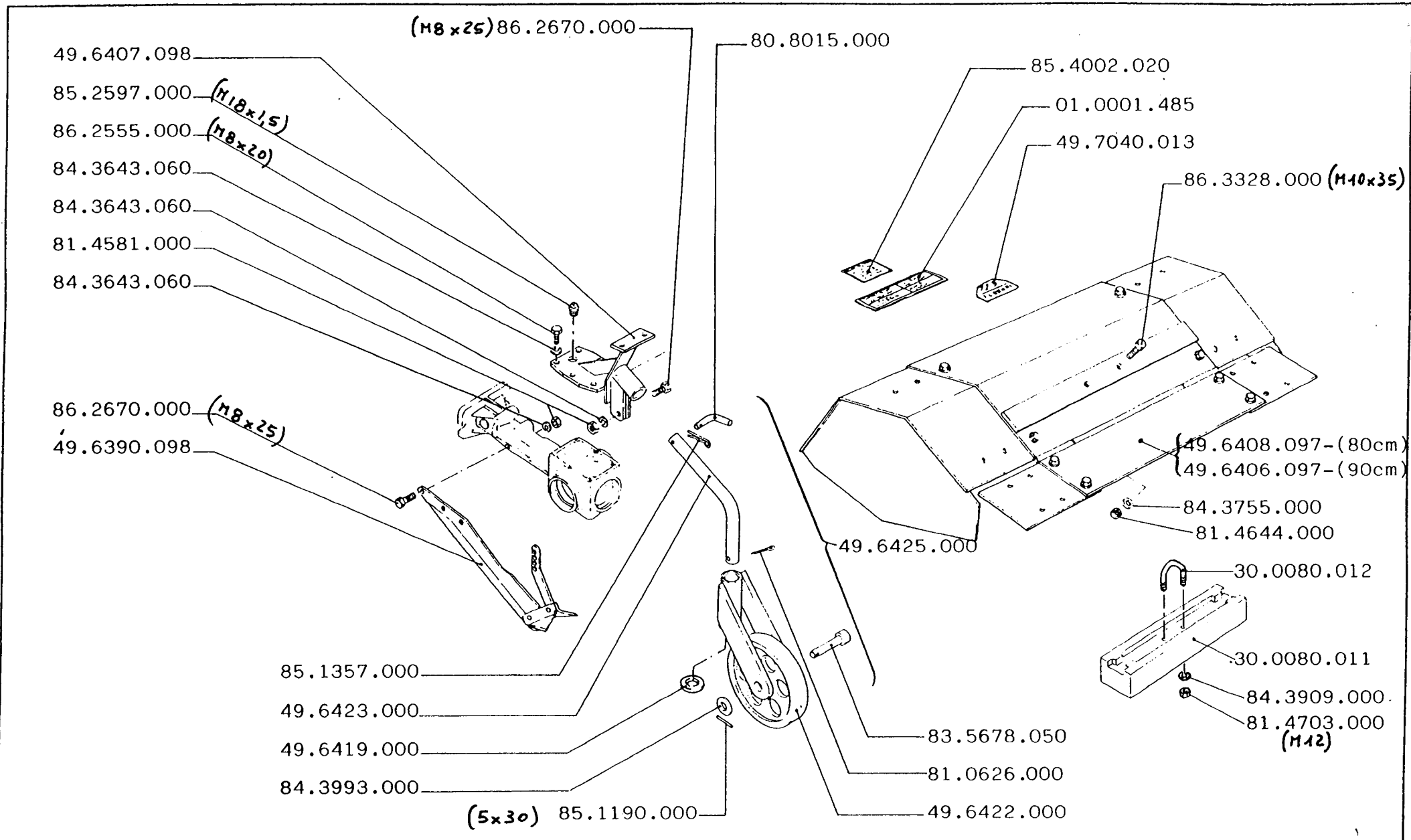

FERRARI

**72 S**

COFANO FRESA E ACCESSORI  
 CAPE FREZA/ACCESSORI  
 ROTARY HOE COVER AND TOOL KIT

CAPO FRESADORA/ACCESORIOS  
 CAPOT FRAISE/ACCESSOIRES  
 HAUBE FRAESE UND WERKZEUGSATZ

PAGINA  
**17.00**  
 DATA  
 01 SET. 1991

☆ cm 80

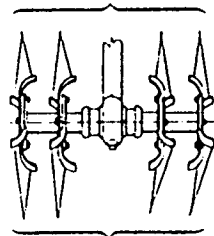

☆ cm 90

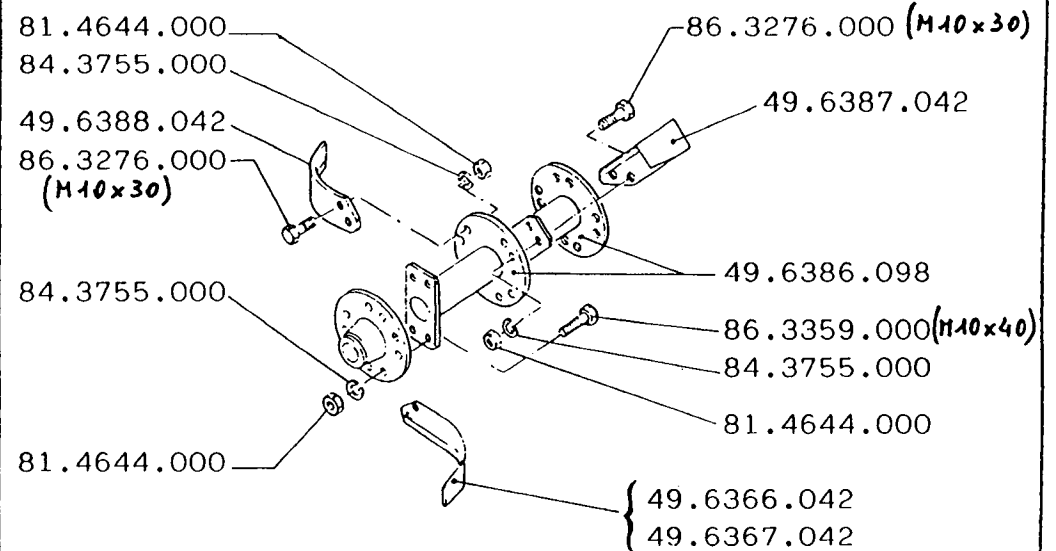
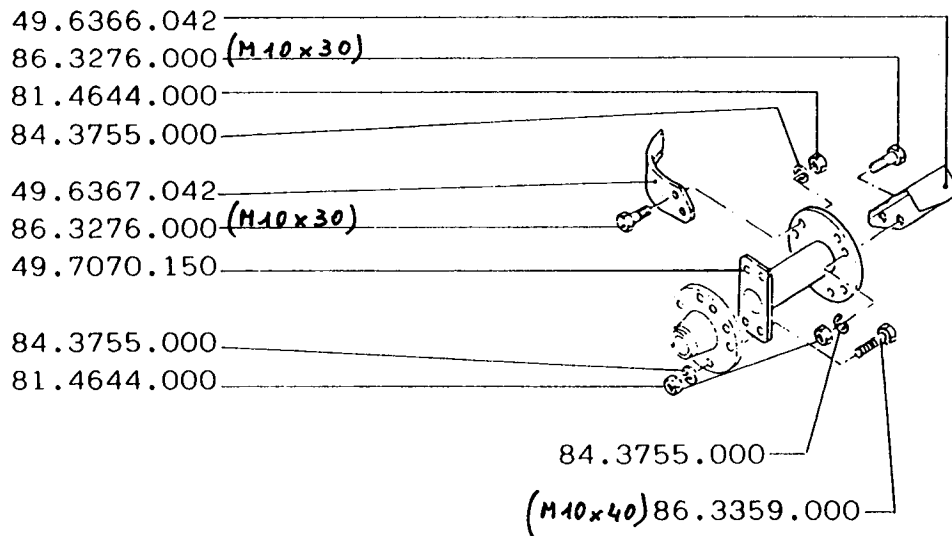
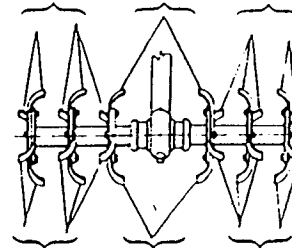

FERRARI

72 S

COLTELLI FRESA  
SEGA FREZA  
ROTARY HOE KNIVES

CUCHILLAS FRESADORA  
COUTEAUX FRAISE  
FRASERMESSER

PAGINA  
18.00  
DATA  
01 SET. 1991